

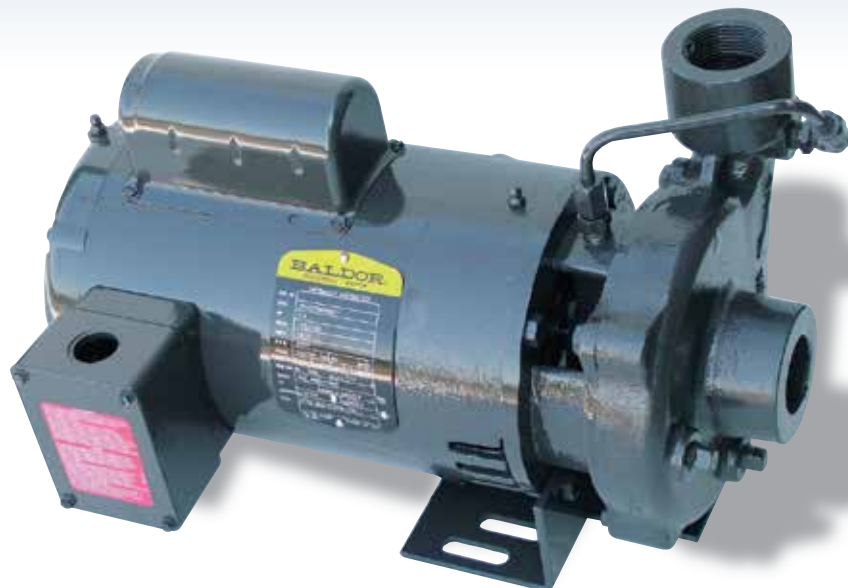

A RUTHMAN COMPANY  
[www.Gusher.com](http://www.Gusher.com)

# General Service Industrial Close-Coupled Pumps

## SC-CC Series



**RUTHMAN**  
Engineering Pump Solutions™

# SC-CC Series

## General Service Industrial Pumps

- Capacities to 450 gpm
- Heads to 160 feet
- Temperatures to 180° F (83° C)
- Pressures to 175 PSIG



## Performance Features For General Service

### Pump Reliability

- All Cast Iron, All 316 Stainless Steel (CF8M) or Stainless Steel (CF8M) Fitted (Shaft & Impeller) Construction

### Ease of Maintenance

- Back Pull-Out Design
- NEMA Standard Shaft Motor
- Self-Setting Mechanical Seal

### Simple Installation

- Compact, Space Saving Close-Coupled Design
- No Pump/Motor Alignment Required

### Motor Information

- Motor Voltage Specifications:  
3/60/208-230/460, 575V
- Motor Enclosures:  
Drip Proof, TEFC, Explosion Proof

For general service pumping or industrial services, the SC-CC Series is a perfect, reliable, and economical solution. The close-coupled design makes installation extremely simple.

The SC-CC Series is also easy to operate and maintain with the added benefit of substantially reduced maintenance costs.

## Services

Water Purification/Filtration  
(Reverse Osmosis, Ultra Filtration)  
Parts Cleaners/Washers  
Deionized Water  
Tank Transfer, Tank Cleaning  
Bottle Washing  
Waste Water  
Scrubbers  
Paint Systems  
OEM Skids  
Seal Barrier Water  
Condensate  
Boiler Circulation  
Cooling Water, Electronics Cooling  
Chillers  
Batch Processing

# SC-CC Series 184-215 Frame

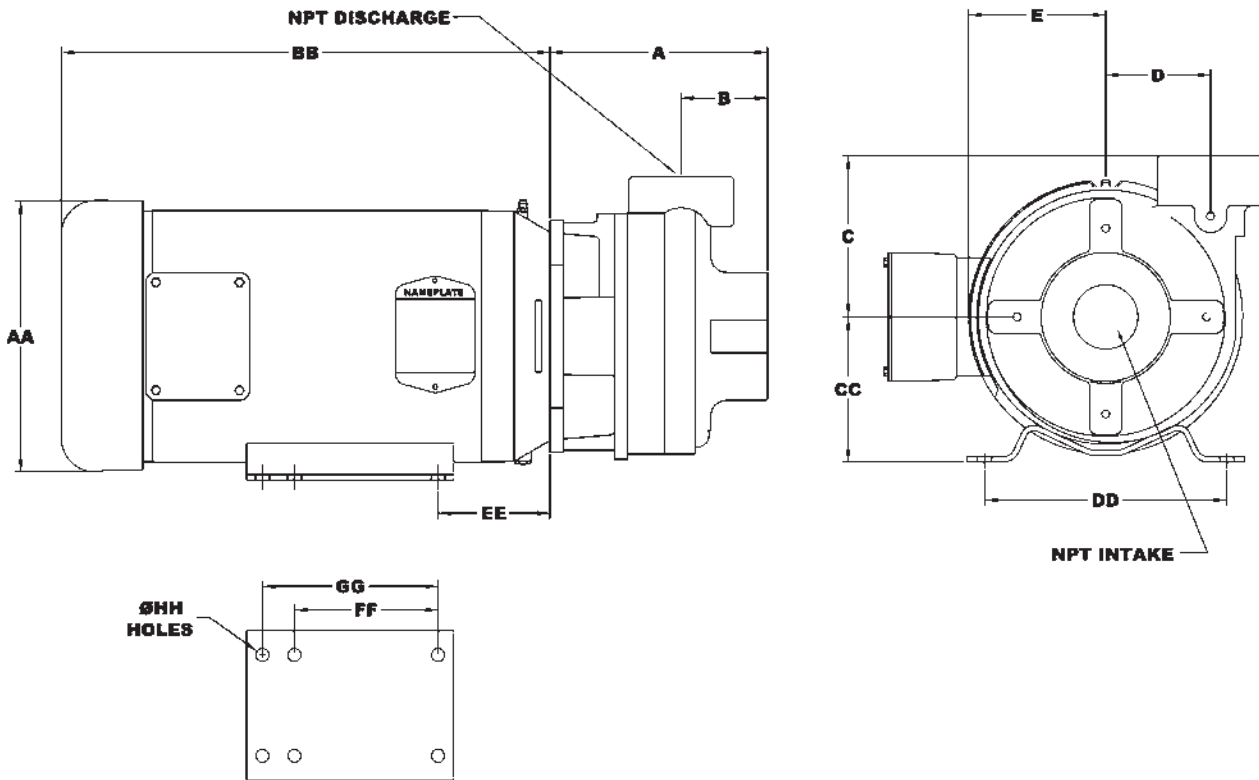

Model	A	B	C	D	E	Discharge	Intake
SC2x2-5.5	6 <sup>13</sup> / <sub>16</sub>	2 <sup>11</sup> / <sub>16</sub>	5	3 <sup>1</sup> / <sub>4</sub>	4	2	2
SC3x3-6.5	8 <sup>1</sup> / <sub>2</sub>	4	6 <sup>5</sup> / <sub>16</sub>	4 <sup>5</sup> / <sub>8</sub>	4 <sup>9</sup> / <sub>16</sub>	3	3

Motor	Frame	AA	BB	CC	DD	EE	FF	GG	HH
5 HP	184	8 <sup>5</sup> / <sub>8</sub>	13 <sup>13</sup> / <sub>16</sub>	4 <sup>1</sup> / <sub>2</sub>	7 <sup>1</sup> / <sub>2</sub>	3 <sup>1</sup> / <sub>2</sub>	4 <sup>1</sup> / <sub>2</sub>	5 <sup>1</sup> / <sub>2</sub>	6-.41
7.5 HP	184	8 <sup>1</sup> / <sub>2</sub>	15 <sup>1</sup> / <sub>4</sub>	4 <sup>1</sup> / <sub>2</sub>	7 <sup>1</sup> / <sub>2</sub>	3 <sup>1</sup> / <sub>2</sub>	4 <sup>1</sup> / <sub>2</sub>	5 <sup>1</sup> / <sub>2</sub>	6-.41
10 HP	215	10 <sup>1</sup> / <sub>4</sub>	15 <sup>5</sup> / <sub>16</sub>	5 <sup>1</sup> / <sub>4</sub>	8 <sup>1</sup> / <sub>2</sub>	4 <sup>1</sup> / <sub>2</sub>	5 <sup>1</sup> / <sub>2</sub>	7	6-.41
15 HP	215	10 <sup>3</sup> / <sub>16</sub>	6 <sup>11</sup> / <sub>16</sub>	5 <sup>1</sup> / <sub>4</sub>	8 <sup>1</sup> / <sub>2</sub>	4 <sup>1</sup> / <sub>2</sub>	5 <sup>1</sup> / <sub>2</sub>	7	6-.41

# SC-CC Series 56J Frame

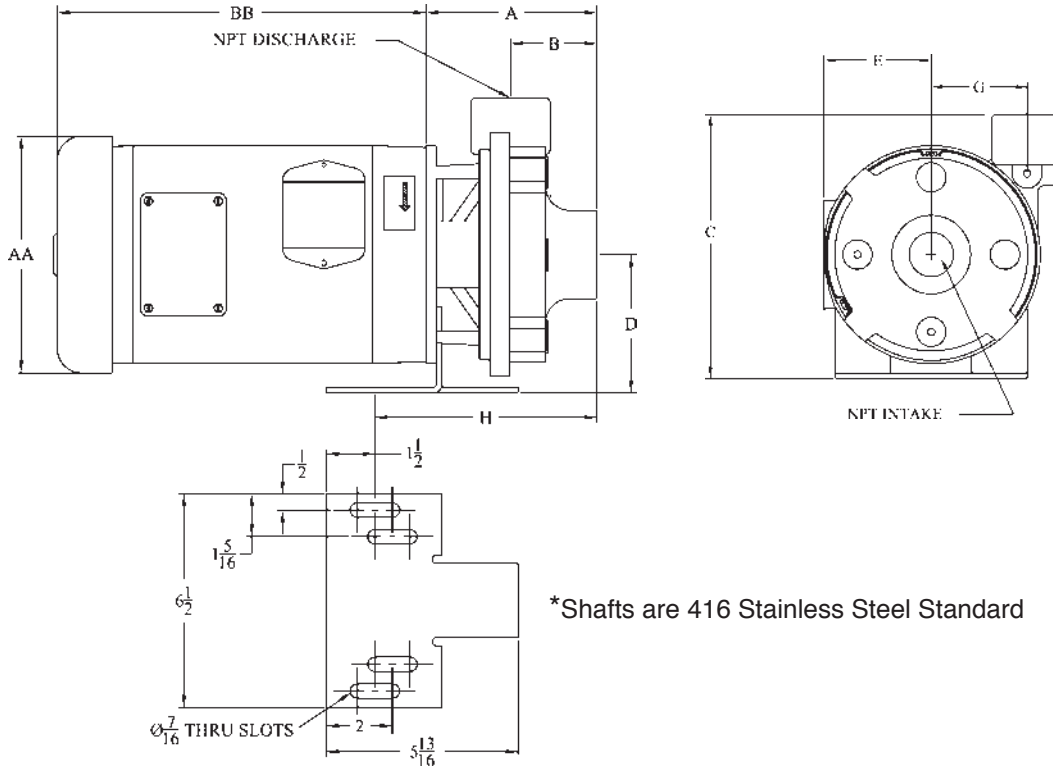

Model	A	B	C	D	E	G	H	Discharge	Intake
SC.75x1.0-3.4E	3 <sup>5</sup> / <sub>8</sub>	1 <sup>1</sup> / <sub>3</sub>	6 <sup>1</sup> / <sub>4</sub>	3 <sup>1</sup> / <sub>2</sub>	2 <sup>3</sup> / <sub>16</sub>	1 <sup>7</sup> / <sub>8</sub>	4 <sup>1</sup> / <sub>8</sub>	.75	1
SC1x1.25-3.4E	3 <sup>5</sup> / <sub>8</sub>	1	6 <sup>1</sup> / <sub>2</sub>	3 <sup>1</sup> / <sub>2</sub>	3	1 <sup>13</sup> / <sub>16</sub>	4 <sup>1</sup> / <sub>8</sub>	1	1.25
SC1x1.25-5E	4 <sup>3</sup> / <sub>4</sub>	2 <sup>1</sup> / <sub>8</sub>	8 <sup>15</sup> / <sub>16</sub>	4 <sup>3</sup> / <sub>16</sub>	3 <sup>11</sup> / <sub>16</sub>	2 <sup>1</sup> / <sub>8</sub>	6 <sup>1</sup> / <sub>4</sub>	1	1.25
SC1x1.25-5.6E	4 <sup>9</sup> / <sub>16</sub>	1 <sup>7</sup> / <sub>8</sub>	7 <sup>15</sup> / <sub>16</sub>	4 <sup>3</sup> / <sub>16</sub>	3 <sup>5</sup> / <sub>16</sub>	3 <sup>1</sup> / <sub>8</sub>	6 <sup>1</sup> / <sub>16</sub>	1	1.25
SC1.25x1.25-5.6E	4 <sup>11</sup> / <sub>16</sub>	2 <sup>3</sup> / <sub>32</sub>	9 <sup>3</sup> / <sub>8</sub>	4 <sup>3</sup> / <sub>16</sub>	3 <sup>5</sup> / <sub>16</sub>	3 <sup>1</sup> / <sub>8</sub>	6 <sup>1</sup> / <sub>4</sub>	1.25	1.25
SC1.25x1.5-5.5E	5 <sup>3</sup> / <sub>16</sub>	2 <sup>5</sup> / <sub>8</sub>	8 <sup>15</sup> / <sub>16</sub>	4 <sup>3</sup> / <sub>16</sub>	3 <sup>9</sup> / <sub>16</sub>	3 <sup>1</sup> / <sub>4</sub>	6 <sup>11</sup> / <sub>16</sub>	1.25	1.5
SC1.5x1.5-4.3E	5 <sup>9</sup> / <sub>16</sub>	1 <sup>15</sup> / <sub>16</sub>	8 <sup>1</sup> / <sub>4</sub>	4 <sup>1</sup> / <sub>4</sub>	3 <sup>1</sup> / <sub>4</sub>	2 <sup>3</sup> / <sub>4</sub>	7	1.5	1.5
SC1.5x1.5-5.6E	4 <sup>11</sup> / <sub>16</sub>	2 <sup>3</sup> / <sub>32</sub>	9 <sup>3</sup> / <sub>8</sub>	4 <sup>3</sup> / <sub>16</sub>	3 <sup>9</sup> / <sub>16</sub>	3 <sup>1</sup> / <sub>8</sub>	6 <sup>1</sup> / <sub>4</sub>	1.5	1.5
SC1.5x2-5.5E	6 <sup>3</sup> / <sub>16</sub>	2 <sup>9</sup> / <sub>16</sub>	8 <sup>15</sup> / <sub>16</sub>	4 <sup>3</sup> / <sub>16</sub>	3 <sup>9</sup> / <sub>16</sub>	3 <sup>1</sup> / <sub>8</sub>	7 <sup>11</sup> / <sub>16</sub>	1.5	2
SC2x2-4.3SE	5 <sup>3</sup> / <sub>4</sub>	2 <sup>1</sup> / <sub>8</sub>	8 <sup>11</sup> / <sub>16</sub>	4 <sup>3</sup> / <sub>16</sub>	3 <sup>5</sup> / <sub>8</sub>	2 <sup>11</sup> / <sub>16</sub>	7 <sup>3</sup> / <sub>16</sub>	2	2
SC2x3-5.5E	6 <sup>15</sup> / <sub>16</sub>	3 <sup>1</sup> / <sub>4</sub>	1 <sup>15</sup> / <sub>16</sub>	4 <sup>3</sup> / <sub>16</sub>	3 <sup>11</sup> / <sub>16</sub>	CL	8 <sup>7</sup> / <sub>16</sub>	2	3

Motor	Frame	AA	BB
.50 HP	56J	6 <sup>3</sup> / <sub>16</sub>	9 <sup>5</sup> / <sub>16</sub>
.75 HP	56J	6 <sup>3</sup> / <sub>16</sub>	9 <sup>5</sup> / <sub>16</sub>
1 HP	56J	6 <sup>3</sup> / <sub>16</sub>	9 <sup>5</sup> / <sub>16</sub>
1.5 HP	56J	7 <sup>3</sup> / <sub>16</sub>	12 <sup>1</sup> / <sub>4</sub>
2 HP	56J	7 <sup>3</sup> / <sub>16</sub>	12 <sup>1</sup> / <sub>16</sub>
3 HP	56J	7 <sup>3</sup> / <sub>16</sub>	11 <sup>3</sup> / <sub>16</sub>

# Pump Selection Curves

SC 2.0x2.0-5.5SE 3500 rpm

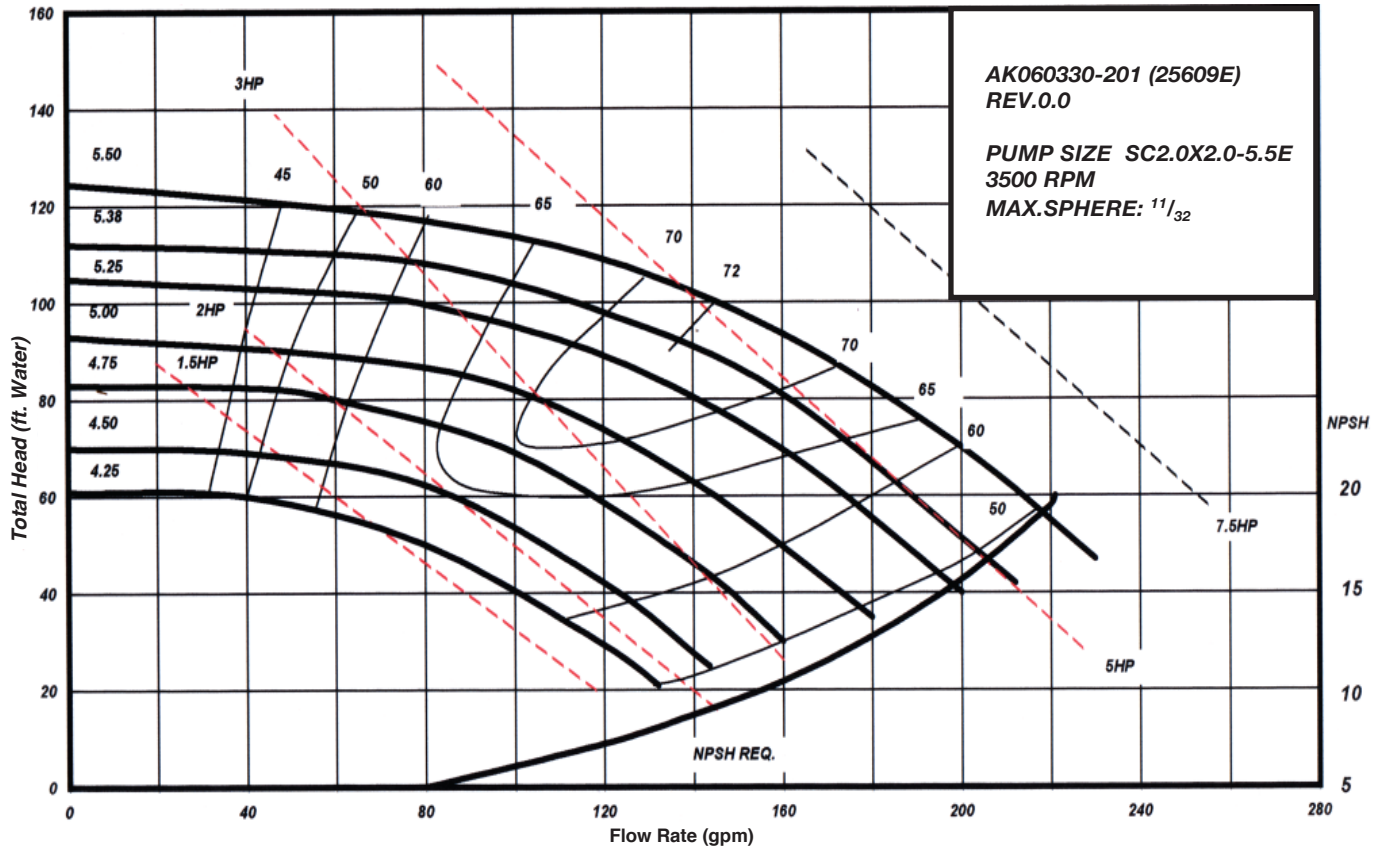

SC 3.0x3.0-6.5E 3450 rpm

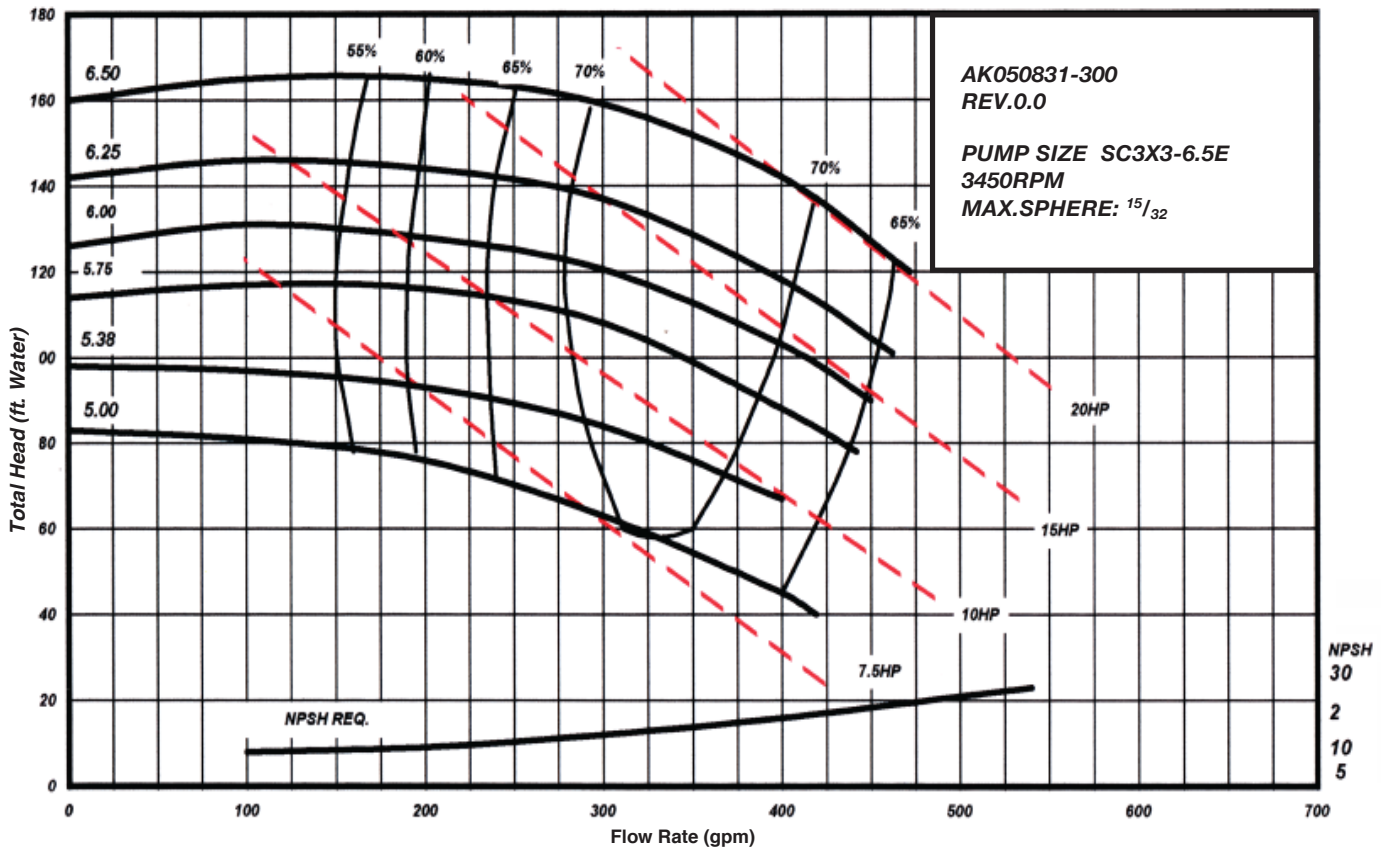

# Pump Selection Curves

SC .75x1.0-3.4SE 3500 rpm

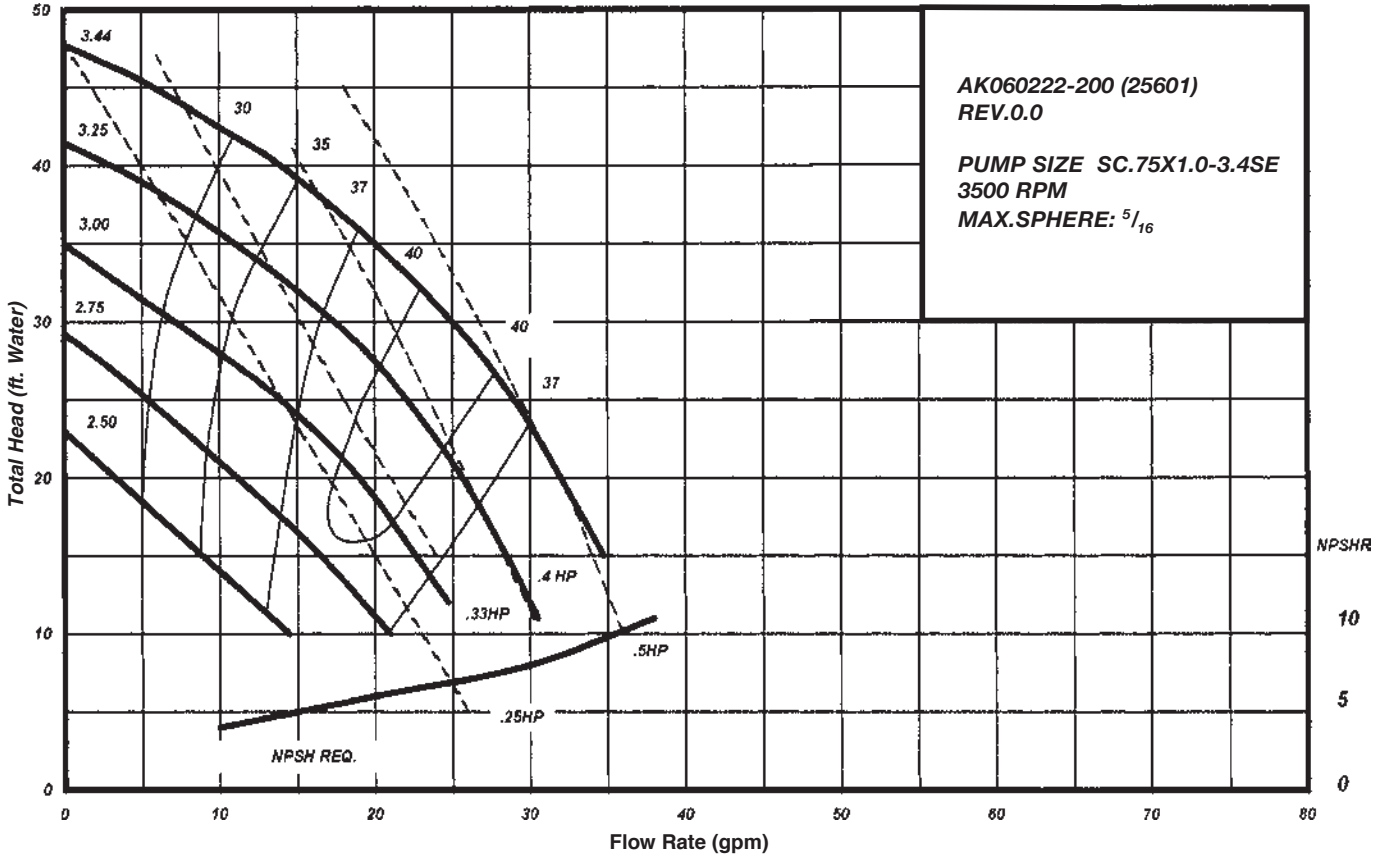

SC 1.0x1.25-3.4SE 3500 rpm

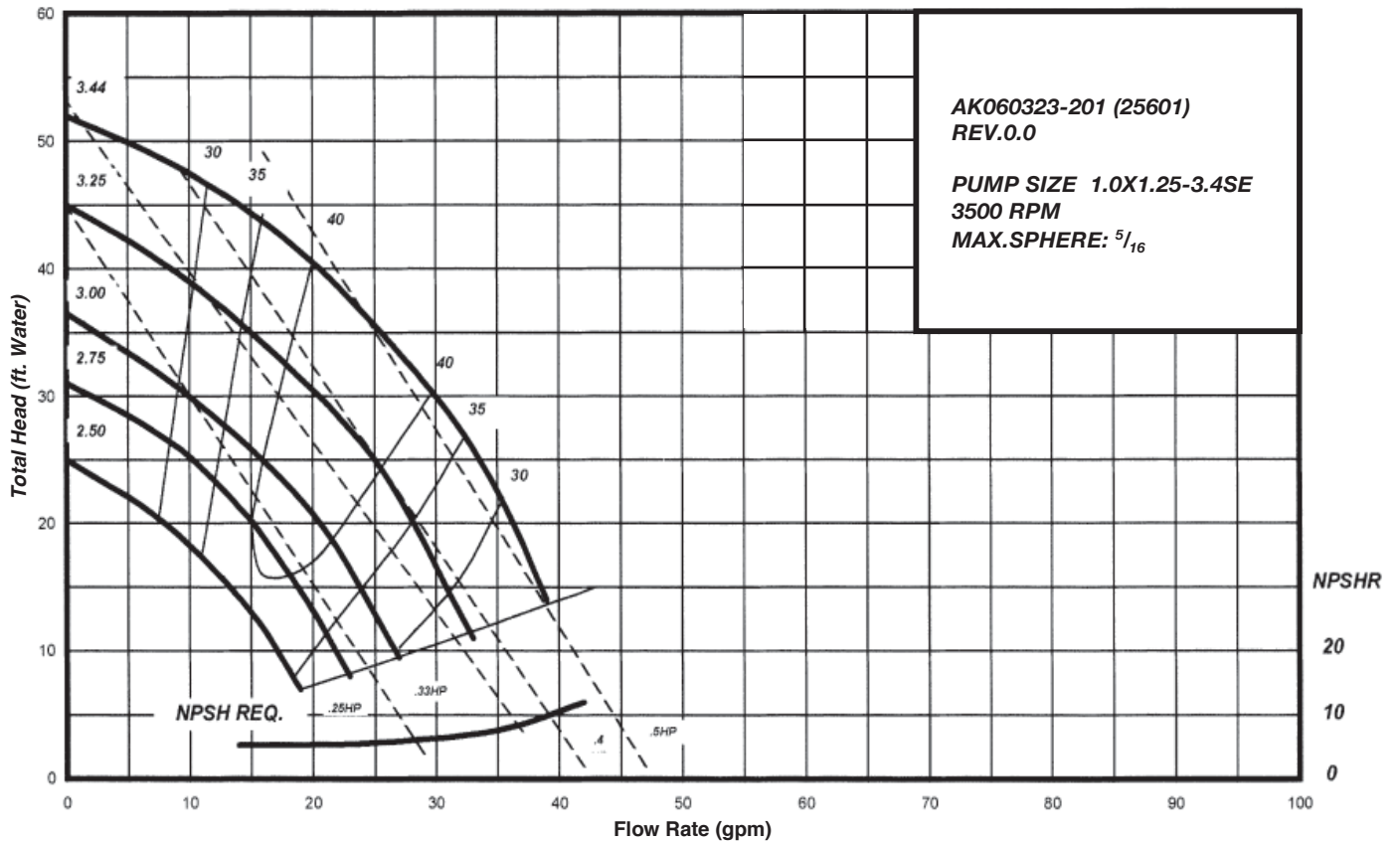

# Pump Selection Curves

SC1.0x1.25-5SE 3500 rpm

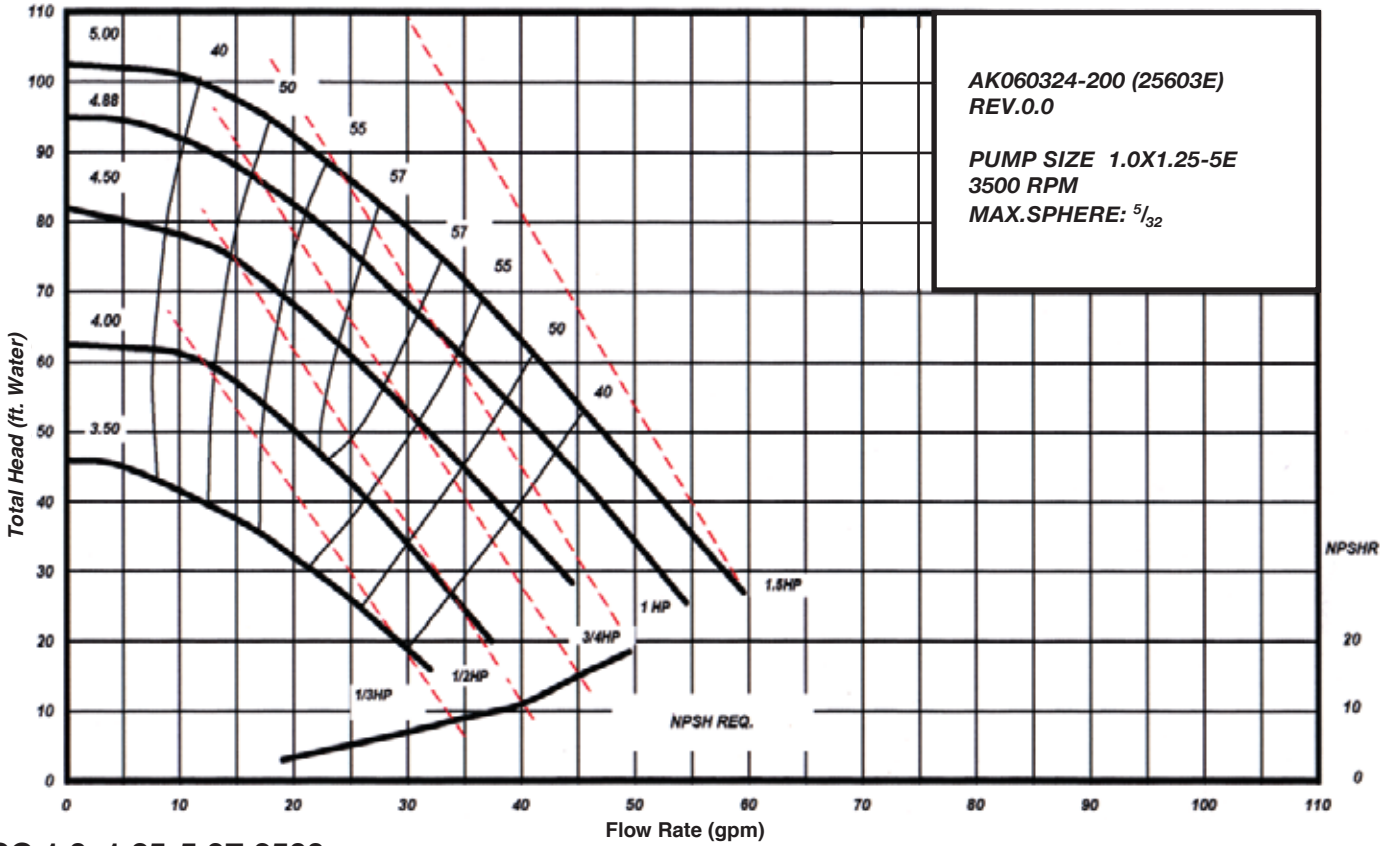

SC 1.0x1.25-5.6E 3500 rpm

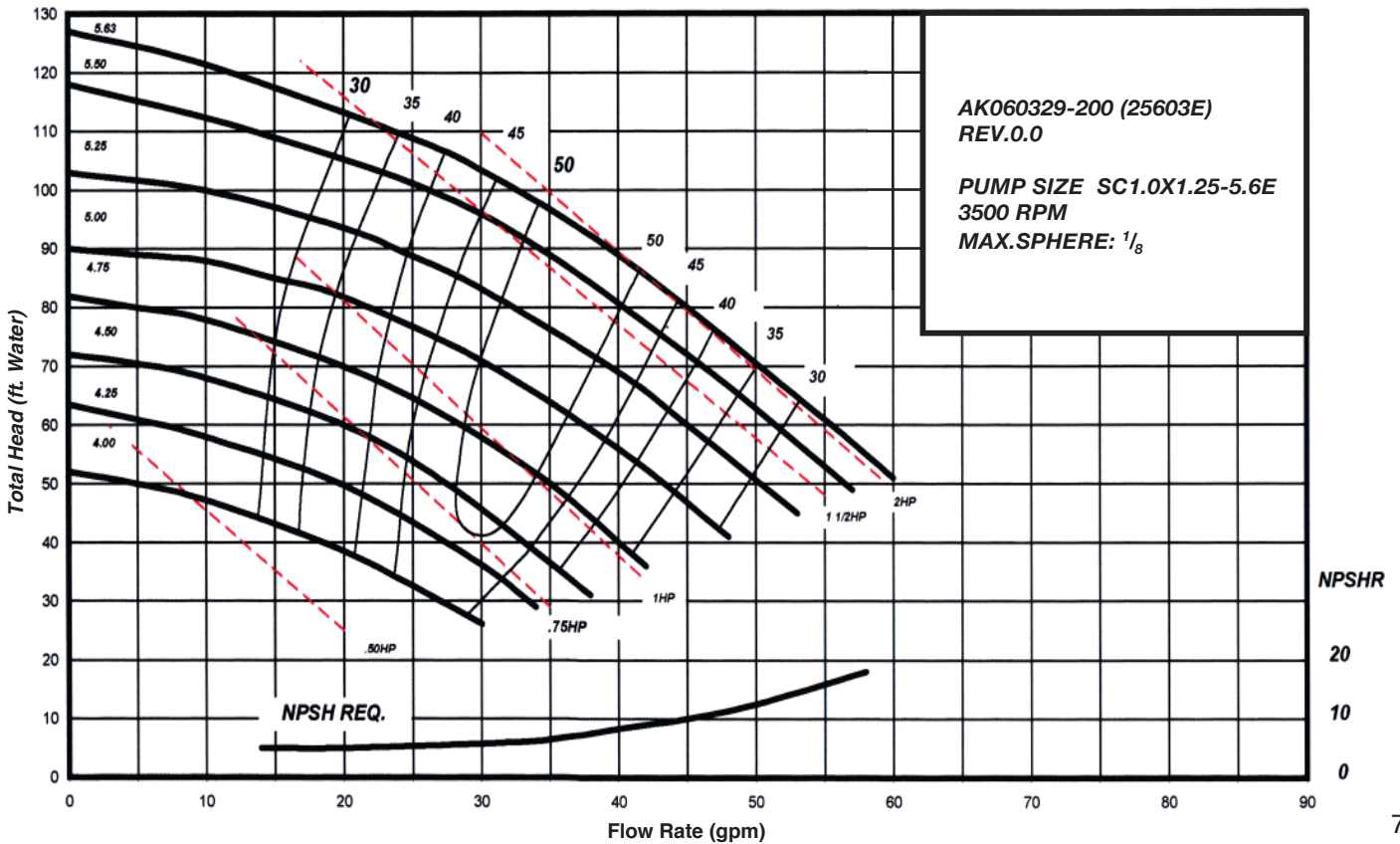

# Pump Selection Curves

SC1.25x1.25-5.6E 3500 rpm—SC 1.5x1.5-5.6SE 3500 rpm

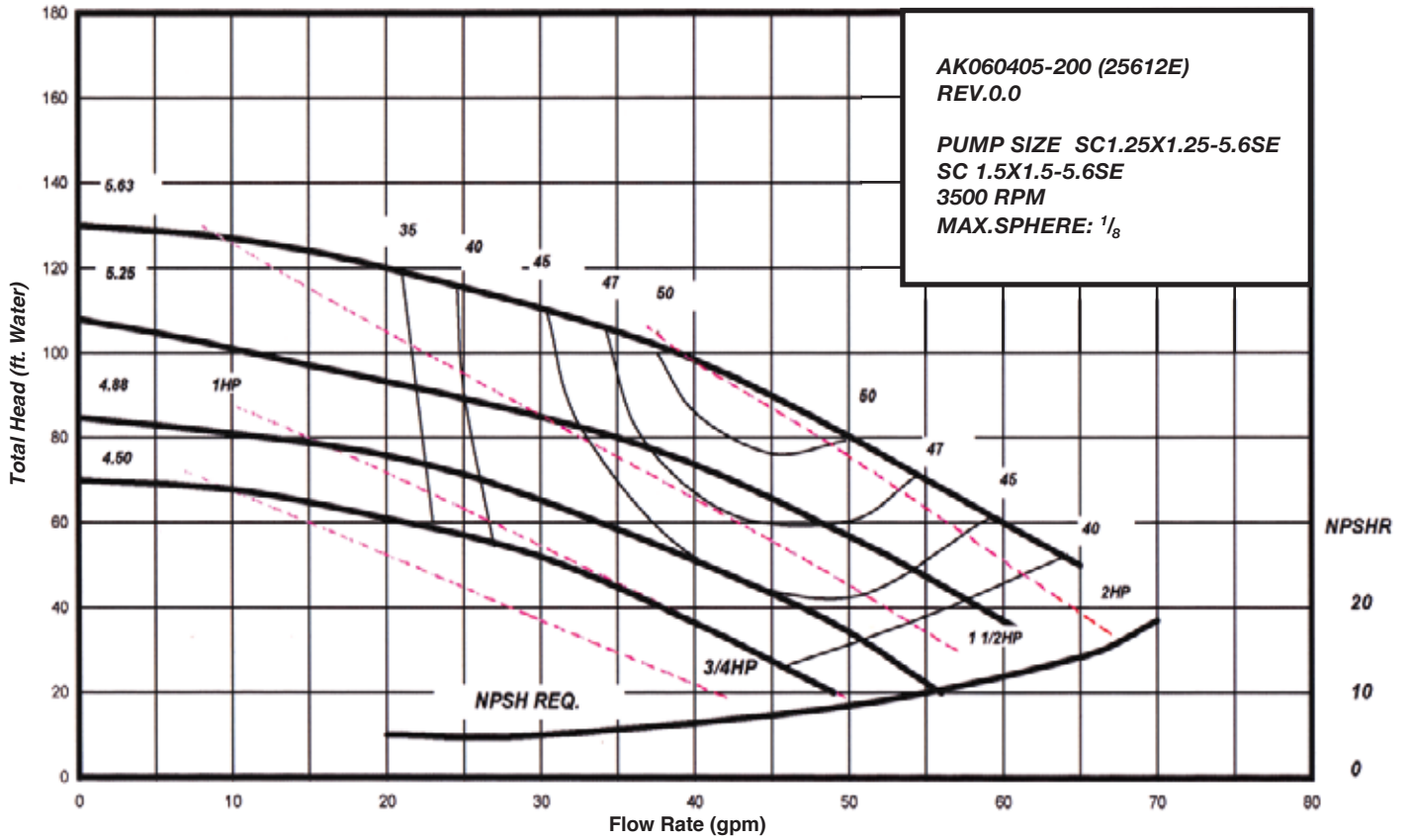

SC1.25x1.5-5.5E 3500 rpm

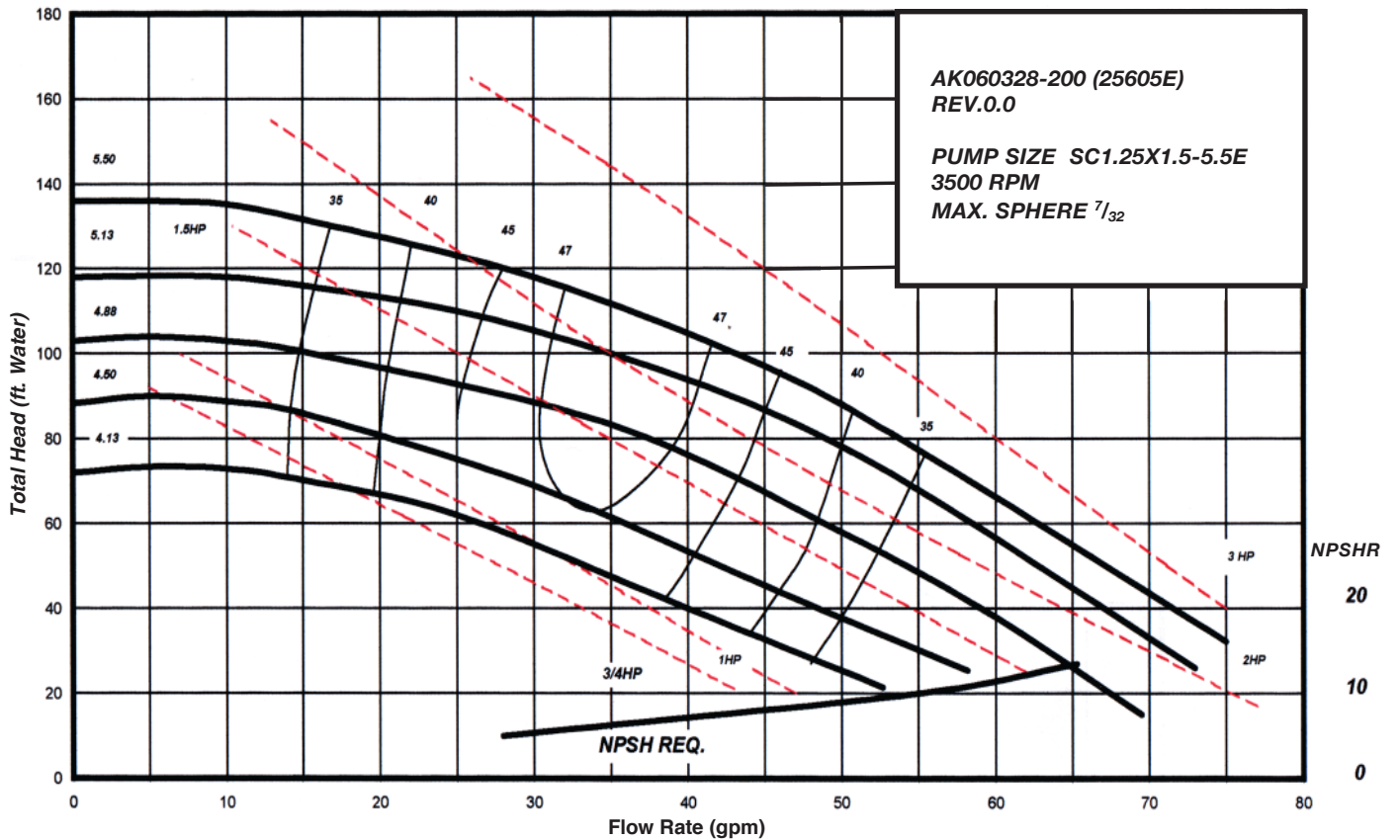



# Pump Selection Curves

SC 1.5x1.5-4.3SE 3500 rpm and SC 2.0x2.0-4.3SE 3500 rpm

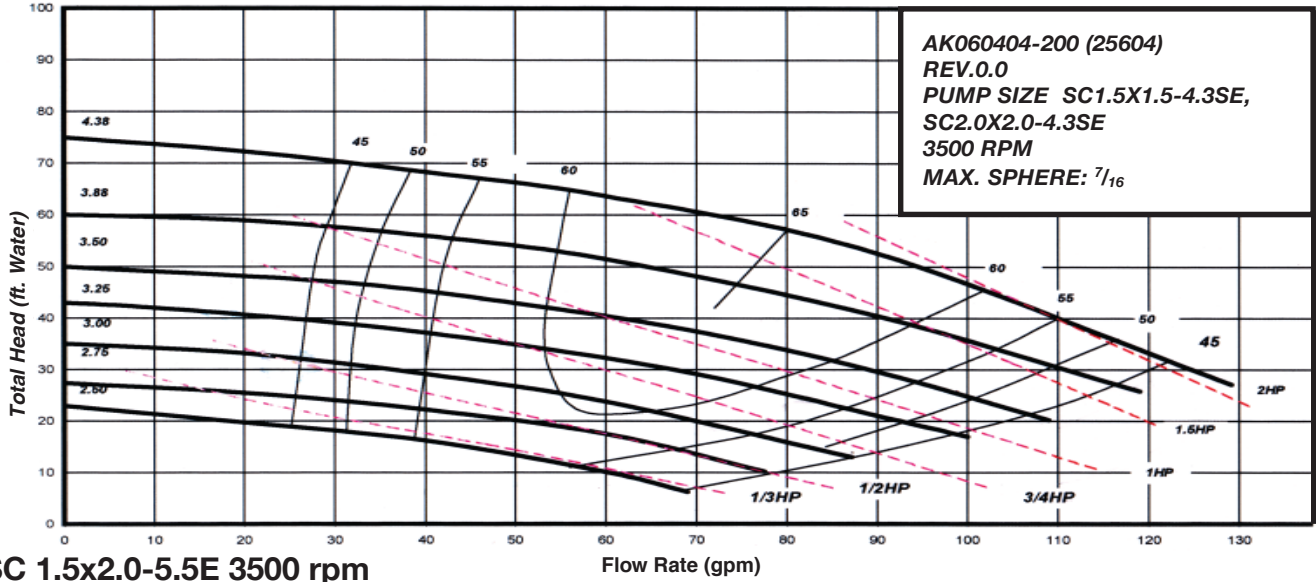

SC 1.5x2.0-5.5E 3500 rpm

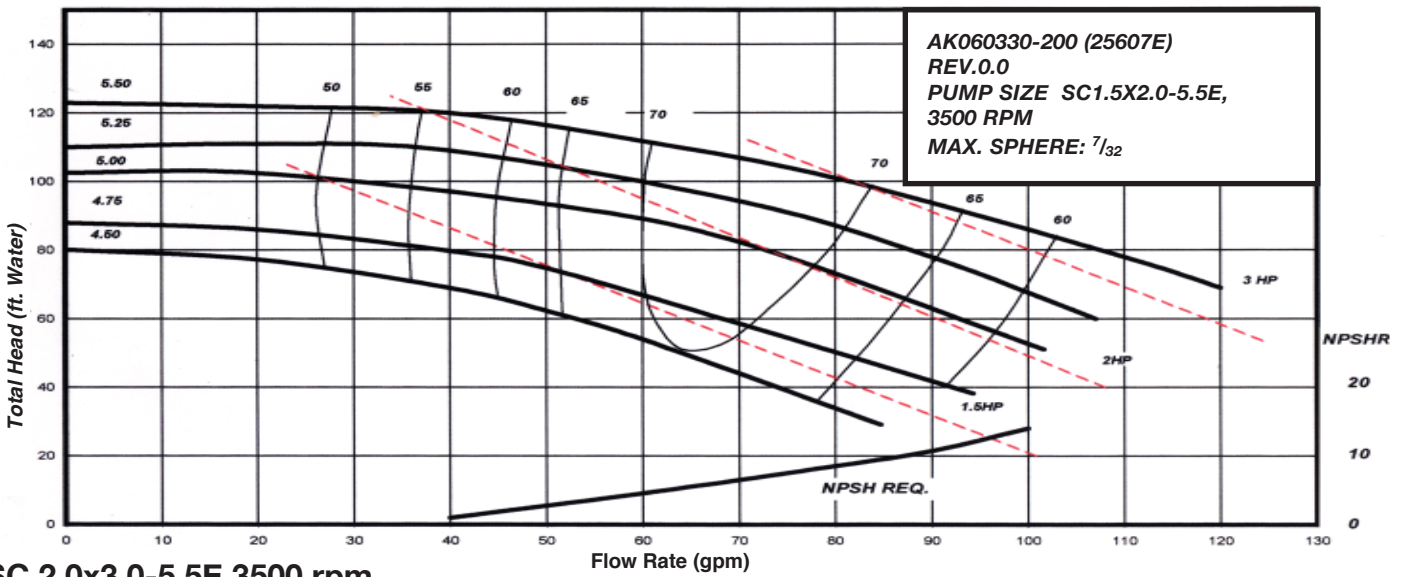

SC 2.0x3.0-5.5E 3500 rpm

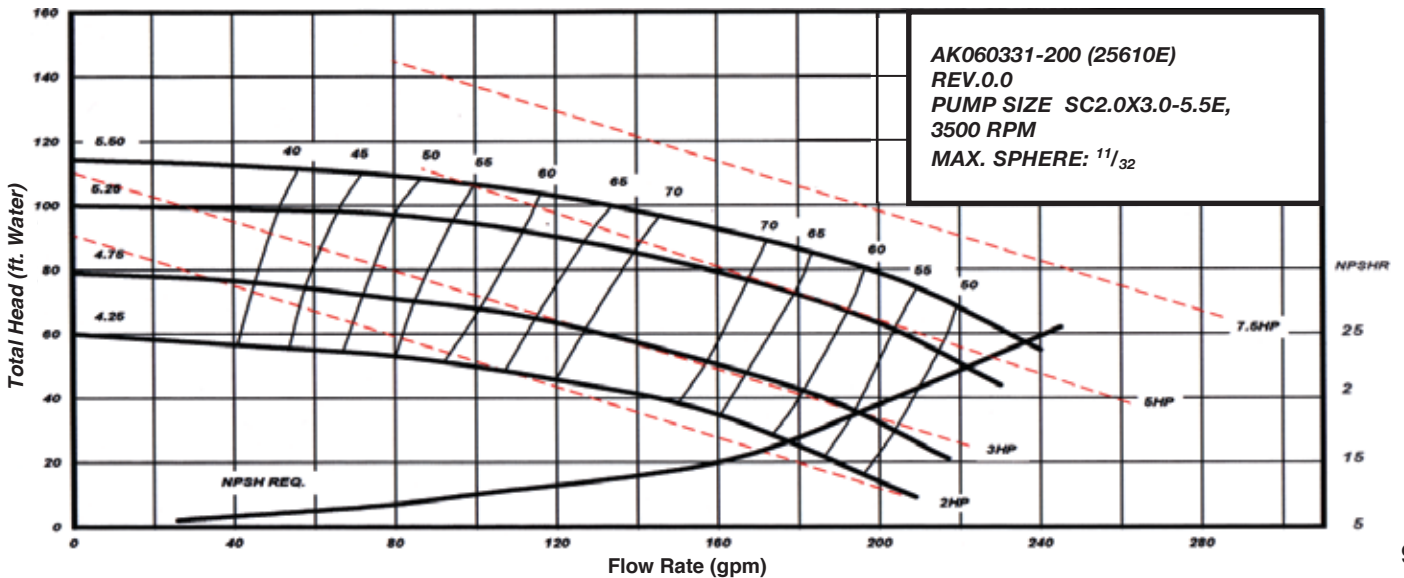

# SC-CC Series 184-215 Frame Diagrams

- 1. MOTOR
- 2. MOTOR BASE
- 3. STEM
- 4. MECHANICAL SEAL
- 5. O-RING
- 6. IMPELLER
- 7. IMPELLER HOUSING
- 8. SHAFT SLEEVE GASKET
- 9. SHAFT SLEEVE
- 10. IMPELLER RETAINING WASHER
- 11. IMPELLER RETAINING SCREW
- 12. KEY

**SC2X2-5.5**

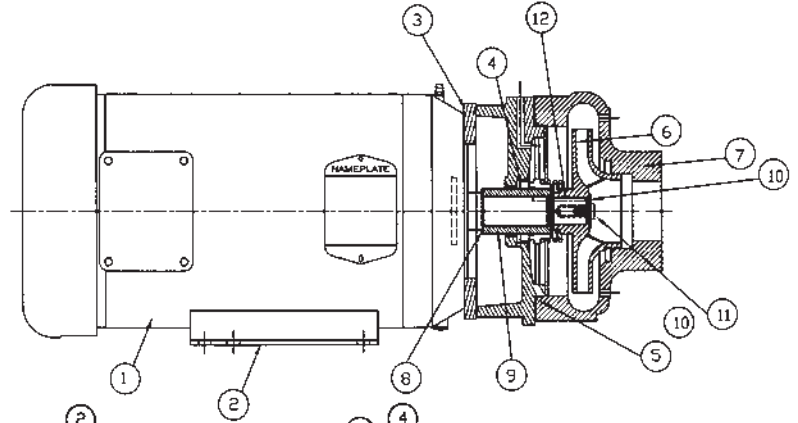

- 1. MOTOR BASE
- 2. MOTOR
- 3. SHAFT
- 4. STEM
- 5. IMPELLER
- 6. IMPELLER HOUSING
- 7. SHAFT SLEEVE GASKET
- 8. HOUSING GASKET
- 9. SHAFT SLEEVE
- 10. WEAR RING
- 11. IMPELLER WASHER
- 12. IMPELLER SCREW
- 13. KEY
- 14. MECHANICAL SEAL

**SC3X3-6.5**

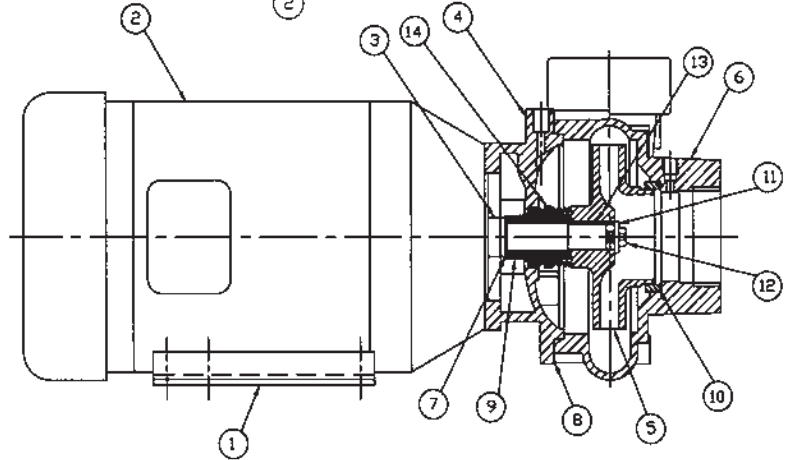

# SC-CC Series EV Frame Diagrams

**SC1.25x1.25-5.6E 3500 rpm**

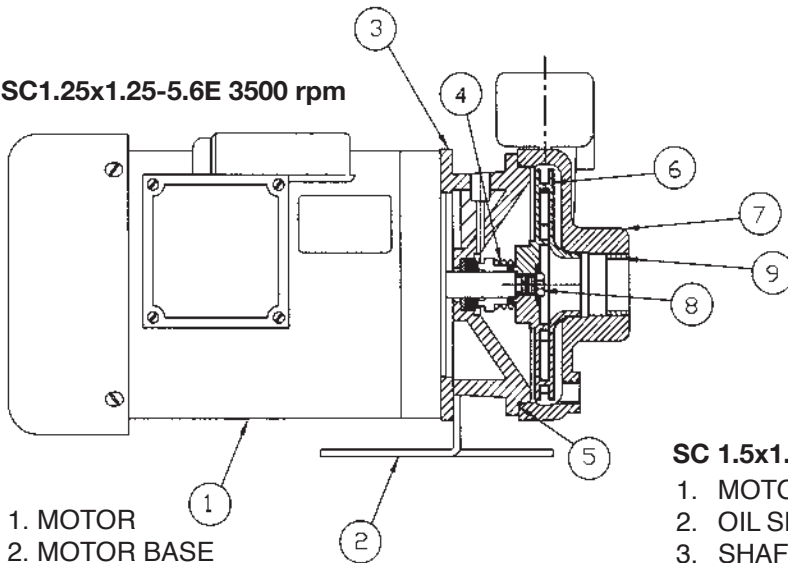

- 1. MOTOR
- 2. MOTOR BASE
- 3. STEM
- 4. MECHANICAL SEAL
- 5. O-RING
- 6. IMPELLER
- 7. IMPELLER HOUSING
- 8. IMPELLER RETAINING NUT
- 9. REDUCER BUSHING

**SC 1.5x1.5-5.62EV 3450 rpm**

- 1. MOTOR
- 2. OIL SEAL
- 3. SHAFT
- 4. STEM
- 5. THROTTLE SLEEVE
- 6. IMPELLER HOUSING
- 7. IMPELLER
- 8. KEY
- 9. RETAINING BOLT
- 10. RETAINING WASHER

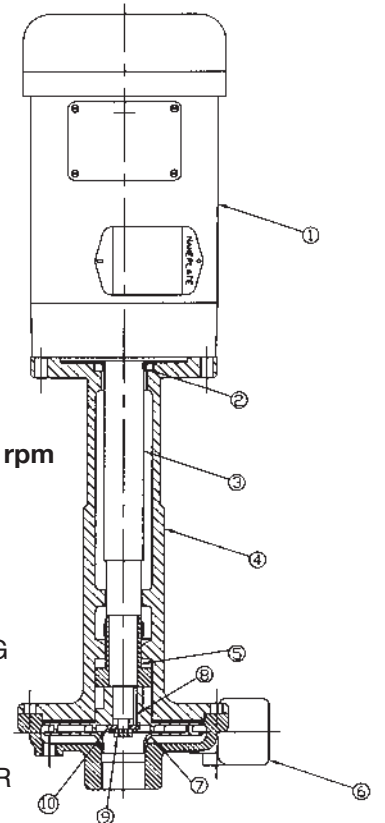

# Parts List

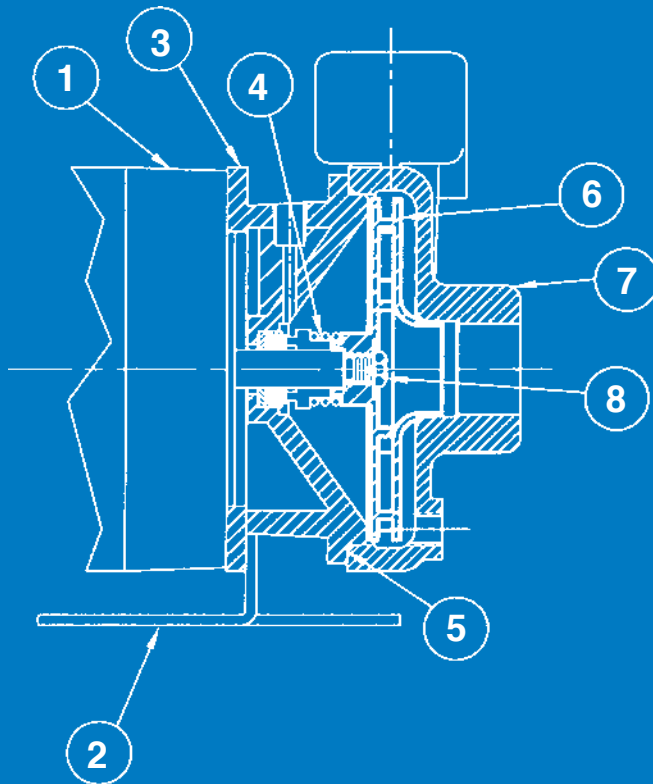

- 1. Motor
- 2. Motor Base
- 3. Stem
- 4. Mechanical Seal
- 5. O-Ring
- 6. Impeller
- 7. Impeller Housing
- 8. Impeller Nut

## Ordering Information

Order the Gusher SC-CC Series Pump to meet your needs by model name. The model name should be specified as follows:

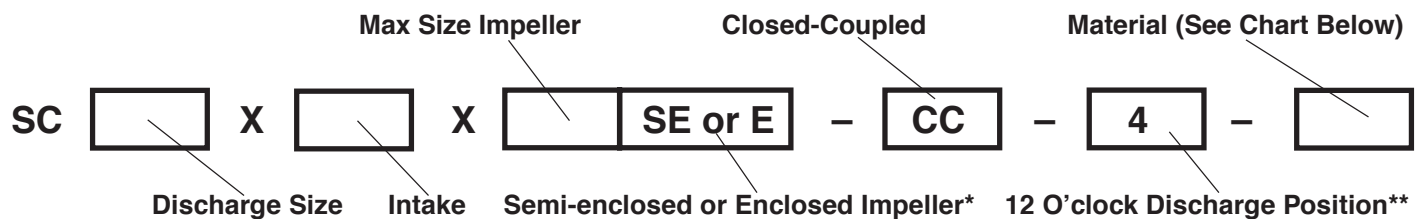

\*Some models are semi-enclosed, others are enclosed

\*\* 4 = Discharge Position = 12 O'clock    1 = Discharge Position = 3 O'clock  
 2 = Discharge Position = 6 O'clock    3 = Discharge Position = 9 O'clock  
 Discharge position is determined while viewing pump from suction end.

Materials of Construction		
Material Designation	Type	Description
A	All Iron	Cast Iron Construction
B	Stainless Steel	316 Stainless Steel Wetted Parts
C	Stainless Steel Fitted	316 Stainless Steel Shaft and Impeller



A RUTHMAN COMPANY

[www.Gusher.com](http://www.Gusher.com)

## GUSHER PUMPS LOCATIONS

### Williamstown Headquarters

115 Industrial Road  
Williamstown, KY 41097  
**Phone:** 859.824.5001  
**Fax:** 859.824.3011  
**Email:** [Info@Gusher.com](mailto:Info@Gusher.com)

### Dry Ridge Manufacturing

22 Ruthman Drive  
Dry Ridge, KY 41035  
**Phone:** 859.824.5001  
**Fax:** 859.824.3011  
**Email:** [Info@Gusher.com](mailto:Info@Gusher.com)

### Dry Ridge Training Facility

3565 Dixie Highway  
Dry Ridge, KY 41035  
**Phone:** 859.824.5001  
**Email:** [Info@Gusher.com](mailto:Info@Gusher.com)

### California Sales & Service

8226 Salt Lake Avenue  
Cudahy, CA 90201  
**Phone:** 323.773.0847  
**Fax:** 323.773.0958  
**Email:** [FConrad@Gusher.com](mailto:FConrad@Gusher.com)

### New Castle Sales & Service

403 North Ninth Street  
New Castle, IN 47362  
**Phone:** 765.529.5624  
**Fax:** 765.521.0008  
**Email:** [GusherNC@Gusher.com](mailto:GusherNC@Gusher.com)

### Gusher Pumps, Shanghai

655 Caosheng Rd, Jiading District  
Shanghai, China 201808  
**Phone:** +86 (021) 55151993  
**Email:** [Flomo@Gusher.com](mailto:Flomo@Gusher.com)

## Ruthman Companies: A family-owned business supplying pumps for over 100 years



Ruthman Companies was co-founded in 1912 by brothers Alois and Edward Ruthman as the "Ruthman Machinery Company." Based in Cincinnati, the company serviced the steamboats that traveled the Ohio River.

In 1924, Alois conceived the first sealless centrifugal pump, coining the term 'coolant pump.' The brothers named this new pump "Gusher," giving birth to what is now Ruthman Companies' flagship brand, Gusher Pumps.

Alois' son Thomas R. Ruthman joined the family business in 1949, growing the business globally through organic growth and the acquisition of complementary technologies. In the early 1990's, Alois' grandson, Thomas G. Ruthman, became the third generation of Ruthmans in the pump business. Over the years, Ruthman Companies has expanded its product line from the original centrifugal coolant pumps to include valves, vertical turbine pumps, positive displacement pumps, gear pumps, and other specialized pump equipment, while upholding its reputation as a leader in the custom engineering of pumps for the most challenging applications.

## RUTHMAN COMPANIES MANUFACTURING DIVISIONS

### BSM Pump Corp.

180 Frenchtown Road  
North Kingstown, RI 02852  
**Phone:** 401.471.6350  
**Fax:** 401.471.6370  
**Email:** [Sales@BSMPump.com](mailto:Sales@BSMPump.com)  
[www.BSMPump.com](http://www.BSMPump.com)

### Fulflo Hydraulic Valves

459 East Fancy Street  
Blanchester, OH 45107  
**Phone:** 937.783.2411  
**Fax:** 937.783.4983  
**Email:** [Info@Fulflo.com](mailto:Info@Fulflo.com)  
[www.Fulflo.com](http://www.Fulflo.com)

### Nagle Pumps

1249 Center Avenue  
Chicago Heights, IL 60411  
**Phone:** 708.754.2940  
**Fax:** 708.754.2944  
[www.NaglePumps.com](http://www.NaglePumps.com)

### Process Systems Inc., Headquarters

23633 Pinewood Street  
Warren, MI 48091  
**Phone:** 586.757.5711  
**Fax:** 586.758.6996  
**Email:** [Sales@PSI4Pumps.com](mailto:Sales@PSI4Pumps.com)  
[www.PSI4Pumps.com](http://www.PSI4Pumps.com)

### Process Systems Inc., Midwest Service

485 N. State Route 341 South  
Mellott, IN 47958  
**Phone:** 765.295.2206  
**Fax:** 765.295.2343  
**Email:** [Sales@PSI4Pumps.com](mailto:Sales@PSI4Pumps.com)  
[www.PSI4Pumps.com](http://www.PSI4Pumps.com)

### RAE Pumps

1212 Steng Street  
Cincinnati, OH 45223  
**Phone:** 513.779.3034  
[www.RuthmanCompanies.com](http://www.RuthmanCompanies.com)

### Ruthman Pumps & Service

1212 Steng Street  
Cincinnati, OH 45223  
**Phone:** 513.559.3546  
[www.RuthmanCompanies.com](http://www.RuthmanCompanies.com)

## RUTHMAN COMPANIES GLOBAL DIVISIONS

### Ruthmann Pumpen, LLC

Thomas-Edison-Str. 11  
D-52499 Baesweiler  
Germany  
**Phone:** +49 (0) 2401 80489-0  
**Fax:** + 49 (0) 2401 80489-20  
**Email:** [Info@RuthmannPumpen.de](mailto:Info@RuthmannPumpen.de)  
[www.RuthmannPumpen.de](http://www.RuthmannPumpen.de)

## RUTHMAN COMPANIES HEADQUARTERS

7236 Tylers Corner Drive  
West Chester, OH 45069  
**Phone:** 513.559.1901  
[www.RuthmanCompanies.com](http://www.RuthmanCompanies.com)



**RUTHMAN**  
Engineering Pump Solutions™

RC19-018/03-20